

Building Lot Erosion & Sediment Control Field Seminar

The statewide NPDES Construction Permit requires builders to provide temporary or permanent site stabilization and sediment control on almost every building site in Minnesota.

This interactive, fast-paced and hands on field course will provide a better understanding of: erosion and sediment control practices and products available; average costs of practices; and the vendors and contractors that provide these products and services.

Don't miss this rare opportunity to get answers about the NPDES program and options for meeting the requirements and see practices as they would be installed on a site.

Who Should Attend?

This field seminar is designed for erosion control designers, Minnesota builders, building inspectors, city and other government staff.

Agenda

Learn about these and more of the latest practices and see them installed on building lots:

- Hydromulch Types 5, 6, 8, 9
- Blankets Category 1-6
- Green Armor
- Several inlet protection practices
- Compost or shredded wood berm
- Compost & Wood chip logs
- Sediment logs/wattles
- Concrete washout options
- Constructions site entrance options
- Rolled erosion control products
- Aero Seed Aide
- and More

Choose your session:

Wednesday, August 25

8:00 a.m. to 10:00 a.m., or

10:30 a.m. to 12:30 p.m.

Please check in 15 minutes prior to start of session.

Questions? Please Contact
Carolyn Dindorf, 763-478-3267
carolyn@fortinconsulting.com

Registration Form

Name _____

Company _____

Street _____

City, State, Zip _____

Phone _____

Email _____

Wednesday, August 25, 2010
Benson Park Cottages, North Mankato

(Register by August 20)

Please select the time you will attend:

8:00 am – 10:00 a.m.

10:30 a.m. to 12:30 p.m.

Registration Fee*:

\$40.00 MECA members

\$45.00 non-MECA members

VISA

MASTERCARD

Credit Card # _____

Expiration Date _____

Amount \$ _____

Please make checks payable
to MECA and send to:

Minnesota Erosion Control Association
215 Hamel Road
Hamel, MN 55340
FAX 763-478-3612

*see cancellation policy on MECA web site

Seminar Location:

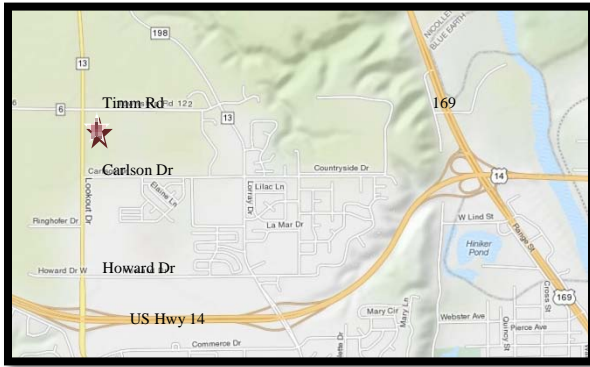

Benson Park Cottages
Development located southeast of
Timm Rd (Twp Rd 122) &
Rolling Green Lane
North Mankato, MN

Travel north on Lookout Drive from US Hwy 14,
turn east on Timm Rd (Twp Rd 122) to Benson
Park Cottages development

(Looks for signs and park on site as
designated)

For more information please contact
the MECA office at 763-478-3267
meca@mnerosion.org
www.mnerosion.org

Minnesota Erosion Control Association
215 Hamel Road
Hamel, MN 55340

A Two-Hour Field Demonstration Session for Builders, Inspectors & Local Government Staff



Building Lot Erosion and Sediment Control BMPs Field Seminar



Wednesday August 25
Benson Park Cottages
North Mankato, MN